

HOW TO POST A FINISHED OBJECT OR PHOTO TO A RAVELRY GROUP if participating in a KAL or group chat

Go to the Ravelry thread (which is in a GROUP which are under the community tab on the front pg)

In the lower right-hand corner – click Reply to Thread



TO ADD TEXT

You can click inside this box and begin typing any message.

TO ADD A PHOTO

At the top of the box -

Click on the 5th icon over – looks like a little picture

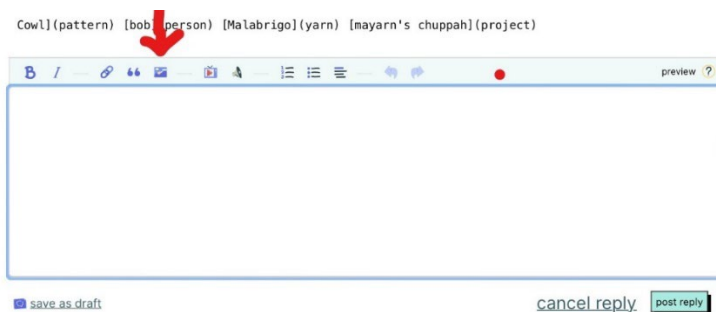

This box will open and you can choose where your photo is coming from

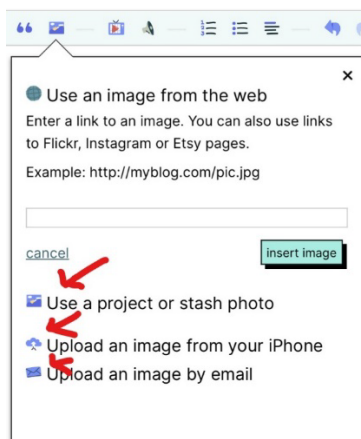

(If you have a project page already and have posted photos there, then use that. If you have the image on your phone, then use that, but you'll need to be doing this on your phone or email the image to yourself from your phone to your computer as an option.)

Once you've clicked your photo to use – it will pop up inside this box so you can know it is the correct one.



Then click: **use this photo** (it will automatically pop into the box with a URL



Then click: **Post reply**

You can always go back in and edit your post



TO EDIT A POST

Click on the three small dots in the bottom right-hand corner

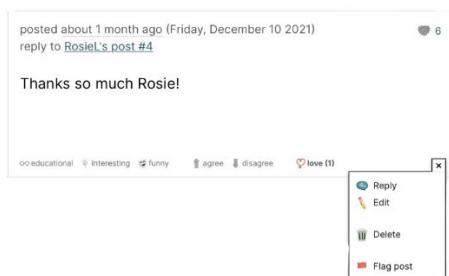

This box will pop up – you can make your selection by clicking on any of the four choices.